

NI "R" Series (w/ Beauty Cap)



- Features**
- Advanced/Reinforced Version of "T series"
 - Solid steel cylinder laser-fused @ web
 - Structurally enhanced (compared to "T series")
 - Thermally broken system
 - Customized Beauty cap
 - 100% Robotic fabrication process (Laser welding)
 - Mullion width and depth: Custom size
 - Glass thickness: 1" AND 1-3/4" available
 - Finish: + Steel: Powder coat (AAMA 2603 / 2605)
+ Aluminum: PVDF 70% (AAMA 2603 / 2605)
 - Steel Grade and Aluminum Alloy:
+ Steel: A36 or higher
+ Aluminum: 6061/6063 (T5 & T6) available
 - Front system:
+ Stick built (Beauty cap and SSG), Toggle SSG and Cassette available
+ Compatible to Schuco / YKK system

- Advantage**
- Thermally Broken system
 - Beauty cap can be customized
 - Custom design @ back side of mullion (Web)
 - Narrow profile
 - Larger day light opening from interior Look
 - Compatible to Schuco and YKK system

Thermal Performance

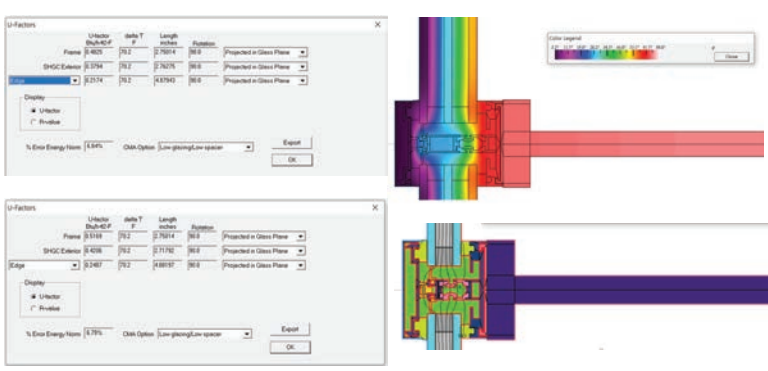

*U-Factor: 0.22 - 0.25
***NFRC 100-2023

Feature	
Manufacture	100% Laser cut / welding
Finish	Powder coat
Connection Type	2 side / 4 side / Captured
Application	Design-centered [Slimness]
Elevation Width (mm)	60
Length (mm)	90 120 150 180 220

Plan Detail

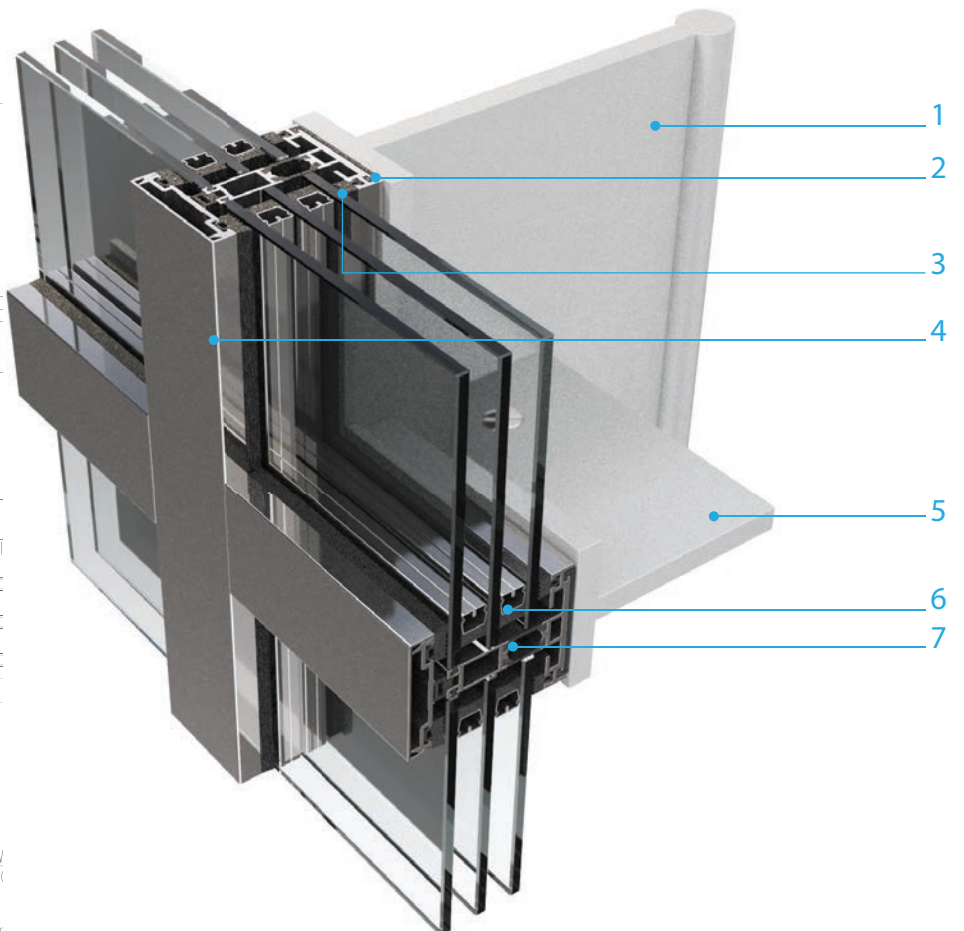
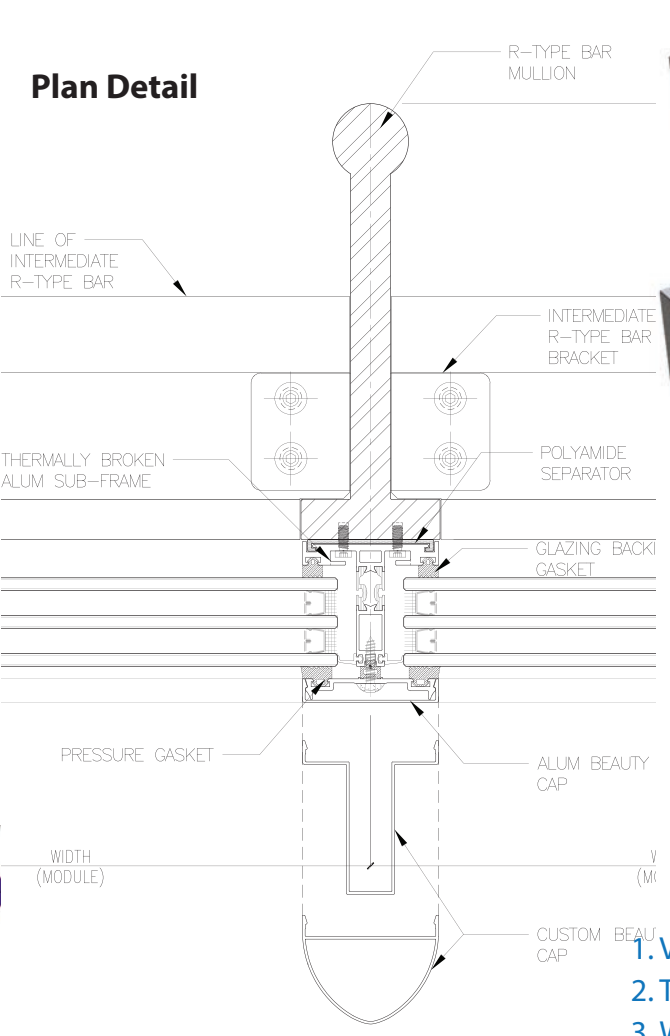

- 1. Vertical "R" Mullion (Laser Fused)
- 2. Thermal separator (Polyamide)
- 3. Wedge Gasket
- 4. Beauty cap (can be customized)
- 5. Horizontal Mullion
- 6. Spacer
- 7. Thermally Broken STS Veener system

