

NI "T" Series

Features

- Most Popular series
- Modern Look "Sharp and Narrow"
- 100% Robotic fabrication process (Laser welding)
- Mullion width and depth: Custom size
- Glass thickness: 1" to 1-3/4" available
- Finish:
 - + Steel: Powder coat (AAMA 2603 / 2605)
 - + Aluminum: PVDF 70% (AAMA 2603 / 2605)
- Steel Grade and Aluminum Alloy:
 - + Steel: A36 or higher
 - + Aluminum: 6061/6063 (T5 & T6) available
- Front system:
 - + Stick built (Beauty cap and SSG), Toggle SSG and Cassette available
 - + Compatible to Schuco / YKK system
- Thermal Separator (Polyamide)

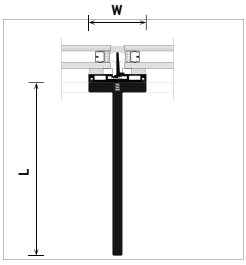

Feature	
Manufacture	100% Laser cut / welding
Finish	Powder coat
Connection Type	2 side / 4 side / Captured
Application	Design-centered [Slimness]
Elevation Width (mm)	60
Length (mm)	90 120 150 180 220



Advantage

- Easy to install
- Free design @ back side of mullion (Web)
- Full glass external look
- Narrow profile
- Larger day light opening from interior Look
- Thermal performance
- Compitible to Schuco and YKK system

Thermal Performance

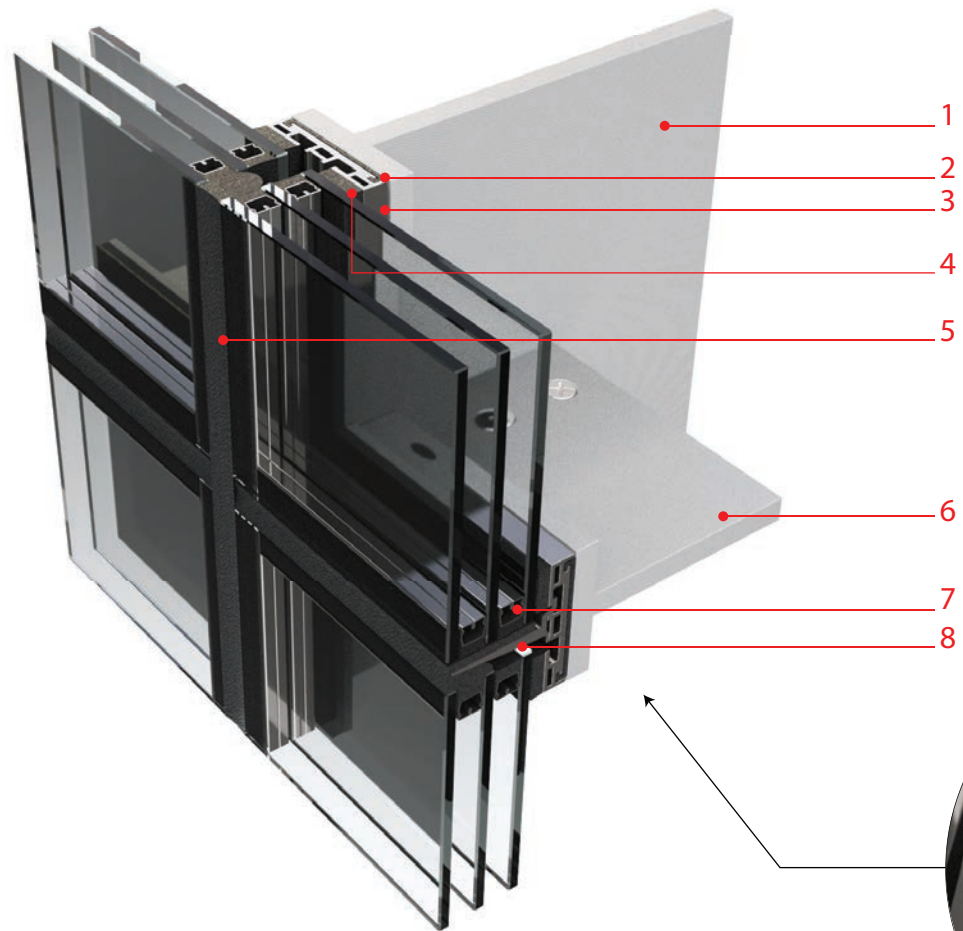
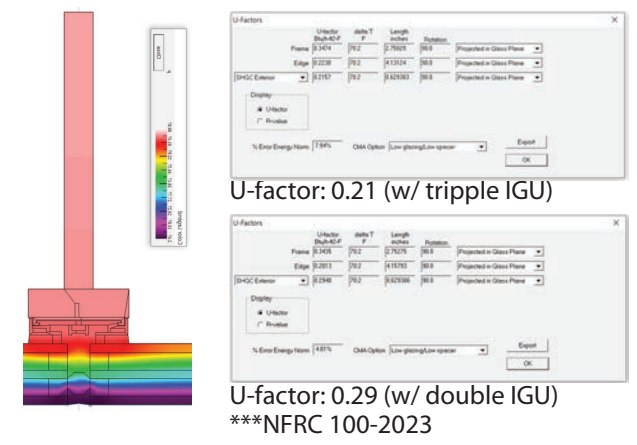

- 1. Vertical "T" Mullion (Laser Fused)
- 2. Thermal seperator (Polyamide)
- 3. Alum. receptor
- 4. Structural sealant
- 5. Weather sealant
- 6. Horizontal Mullion
- 7. Spacer
- 8. Glass chair

Plan Detail

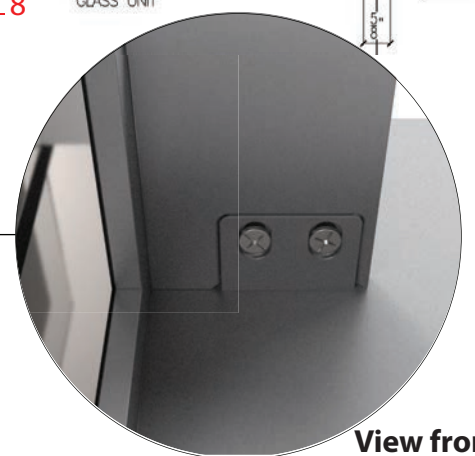
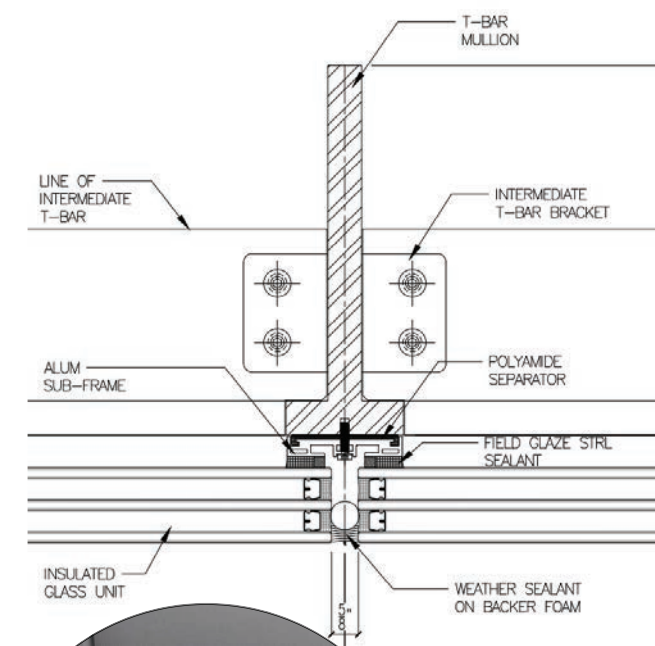

View from Below

